

MAINTAINED GROUNDS

- FIVE-A-SIDE SOCCER - 1,2,3
- FOOTBALL M.O. PARK 12
- FOOTBALL PARK 10
- LACROSSE
- SOCCER PARK 10 NECK
- SOCCER PARK 10
- SOCCER GRADS
- SOCCER M.O. PARK 12 - 1,2,3
- CRICKET M.O. PARK 12 - 1
- CRICKET M.O. PARK 12 - 2
- CRICKET PARK 10 - 1
- CRICKET PARK 10 - 2
- CRICKET GRADS
- TENNIS PARK 10
- TENNIS M.O. PARK 12
- PRACTICE PITCHES (HARD)
- PRACTICE PITCHES (TURF)
- INFORMAL DAY USE AREA (WINTER)
- INFORMAL DAY USE AREA (SUMMER)
- FLOODLIGHTS
- EXTENT OF LICENSE AREA MAINTAINED

AREA USED BY PARKS & GROUNDS CONTRACTOR



BUILDING INDEX

- 1 TORRENS RIVER BOATHOUSE
- 3a CHANGING ROOMS GRADUATES - PARK 10
- 3b PUBLIC TOILETS AND STORE - PARK 10
- 3c WORKSHOP - PARK 10
- 3d LACROSSE CHANGEROOM - PARK 10
- 3e GRANDSTAND - PARK 10
- 3f SCORE BOX - PARK 12
- 3g MAIN OVAL GRANDSTAND - PARK 12
- 3h MAIN OVAL IMPLEMENT SHED - PARK 12
- 3i WOMENS CHANGEROOM - PARK 12
- 3j MAIN OVAL GROUNDSMAN WORKSHOP - PARK 12
- 3k PUMPING STATION - PARK 10
- 3l PUMPING STATION - PARK 12

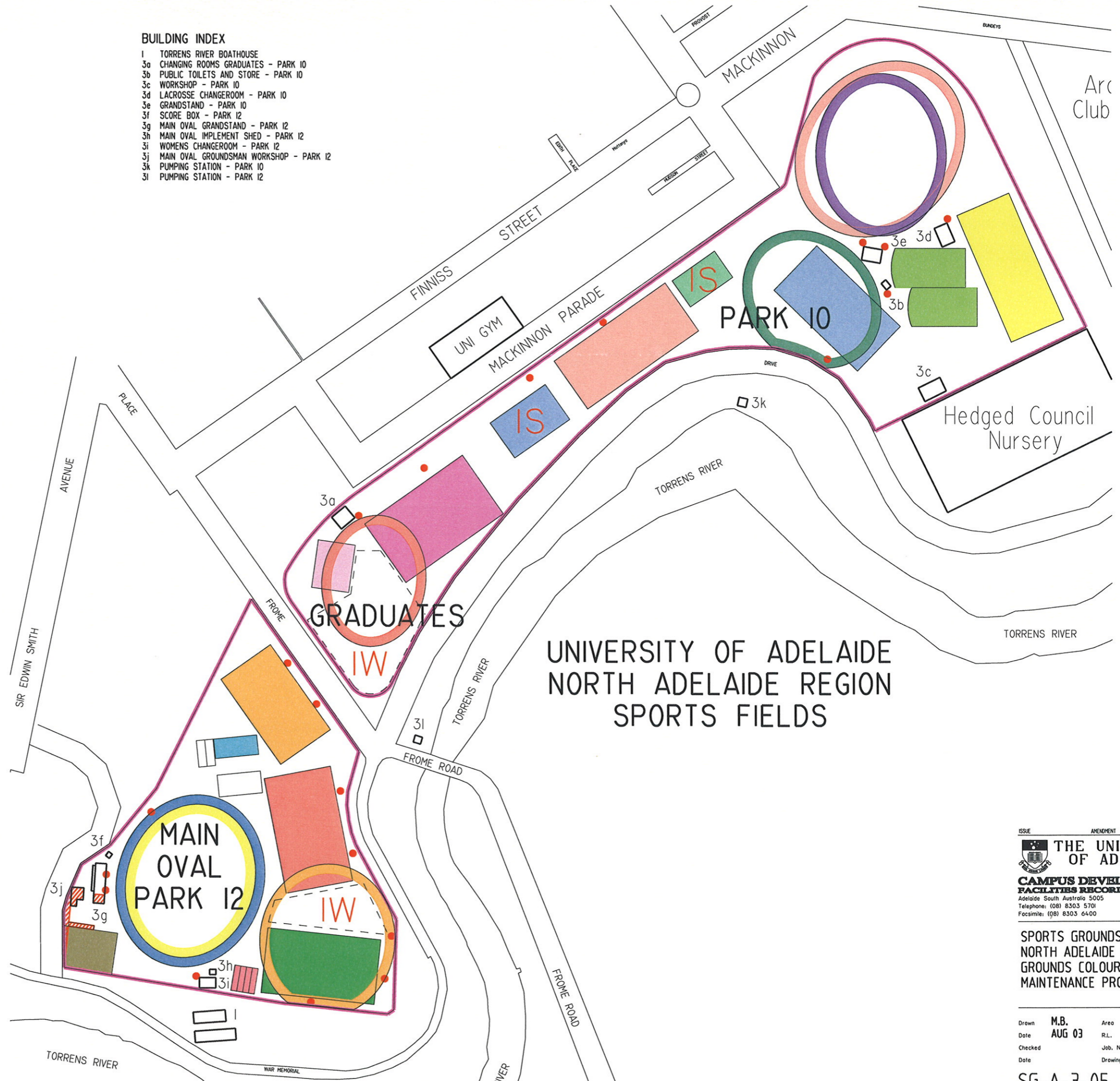

**UNIVERSITY OF ADELAIDE
NORTH ADELAIDE REGION
SPORTS FIELDS**



The contractors must verify all appropriate site dimensions before commencing work. All shop drawings must be approved by Campus Development



Scales :

ISSUE _____ AMENDMENT _____ DATE _____

THE UNIVERSITY OF ADELAIDE

CAMPUS DEVELOPMENT FACILITIES RECORDS

Adelaide South Australia 5005
Telephone: (08) 8303 5701
Facsimile: (08) 8303 6400

© COPYRIGHT

**SPORTS GROUNDS (3)
NORTH ADELAIDE SITE PLAN
GROUNDS COLOUR CODED
MAINTENANCE PROFILES**

Drawn **M.B.** Area
Date **AUG 03** R.L.
Checked Job. No.
Date Drawing No.

SG-A-3-05